

CE XD9000

SERIAL NO. 628504 AND UP

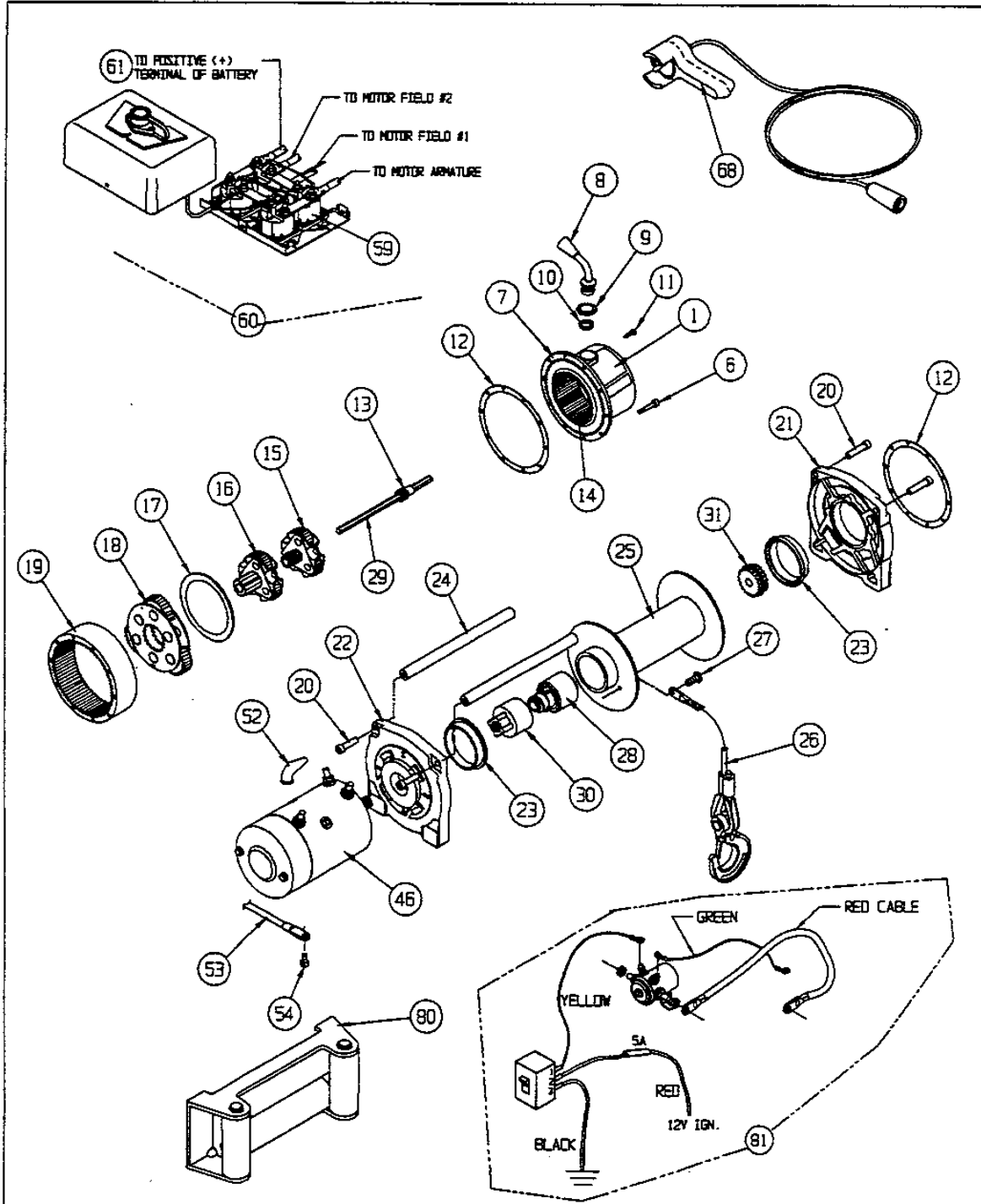

WARN CE XD9000 WINCH REPLACEMENT PARTS LIST			
(P/N 285002)			
SERIAL NO. 628504 AND UP			
ORDERING INFORMATION:			
When ordering please give Warn Model, Serial Number & Battery voltage.			
Parts may be obtained through your local dealer or distributor.			
ITEM	QTY	PART NO.	DESCRIPTION
1	1	38306	LABEL, KIT, CE XD9000
2	1		LABEL, CE
3	1		LABEL DRUM ROTATION
4	1		WARNING, HOT
5	1		LABEL, NAMEPLATE
6	10	13850	SOCKET HEAD CAPSCREW,
			10-24 x 2 1/2
7	1	37131	END HOUSING, ASSEMBLY
8	1		CLUTCH LEVER
9	1		RETAINER, SEAL
10	1		SEAL, O-RING
11	1		CLUTCH LEVER DETENT SCREW
12	2	13848	GASKET
13	1	13874	SUN GEAR
14	1	13839	RING GEAR, SLIDING
15	1	34339	CARRIER ASSEMBLY, STAGE 1
16	1	34342	CARRIER ASSEMBLY, STAGE 2
17	1	13826	THRUST BEARING
18	1	28432	CARRIER ASSEMBLY, STAGE 3
19	1	25308	RING GEAR
20	4	60451	SOCKET HEAD CAPSCREW,
			5/16-18 x 1-1/4,
			SELF TAPPING
21	1	25986	DRUM SUPPORT, GEAR TRAIN
22	1	25985	DRUM SUPPORT, MOTOR
23	2	13831	DRUM BUSHING
24	2	32408	TIE ROD
25	1	26107	DRUM ASSEMBLY
26	1	38314	WIRE ROPE ASSY, 5/16x100' W/THIMBLE
27	1	13699	BUTTON HEAD CAPSCREW
28	1	32455	BRAKE ASSEMBLY
29	1		HEX SHAFT, 10.1
30	1		MOTOR COUPLER
31	1		DRIVE SPLINED W/RETAINING RING
46	1	39972	MOTOR, 12 VDC, BIC

WARN CE XD9000 WINCH REPLACEMENT PARTS LIST			
ORDERING INFORMATION:			
When ordering please give Warn Model, Serial Number & Battery voltage.			
Parts may be obtained through your local dealer or distributor.			
ITEM	QTY	PART NO.	DESCRIPTION
52	3	2090	BOOT, ELECTRICAL TERMINAL
53	1	15901	CABLE ASSEMBLY, ELECTRICAL, 2 GA x 72" (BLACK)
54	1	26744	HEX HEAD CAPSCREW, M8 x 1.25 x 12MM
59	4	28396	SOLENOID, UPRIGHT TERMINAL
60	1	39968	WINCH CONTROL, 12 VDC
61	1	33295	CABLE ASSEMBLY, ELECTRIC, 2GA x 72" RED
68	1	38626	REMOTE CONTROL ASSY.
80	1	5742	ROLLER, FAIRLEAD
81	1	32959	POWER INTERRUPT KIT

P/N 36622 REV C0

SERVICE INSTRUCTIONS

Should you encounter a problem during installation or operation of your winch, please follow these steps toward resolving the problem:

1. Refer to your operator's guide and installation instructions. It has illustrations and detailed information on the installation and safe and proper operation of your winch. It also includes a replacement parts list and assembly diagrams. If you are unable to resolve the problem, then go to step 2.
2. Contact your dealer where you purchased your winch. If, after discussing the problem with their parts and service staff, you are still unable to resolve the problem then go to step 3.
3. Call an Authorized WARN Service center from the list provided on the back of the warranty sheet included with the product. When calling, please have the following information available: winch model number and purchase date, make, model and year of vehicle.
4. If you are unable to resolve the problem to your satisfaction, please call Warn Industries Customer Service at: 1-800-543-9276. When calling, please have the following information available: winch model number and purchase date, make, model and year of vehicle. You may also contact Warn Industries by visiting our website: www.warn.com

SERVICE/UPGRADE KITS

KIT#	PN	ITEM	QTY	DESCRIPTION
KIT 1	92083			END HOUSING KIT
		1	1	END HOUSING
		2	1	CLUTCH LEVER
		3	1	SEAL, O-RING
		4	1	CLUTCH LEVER DETENT SCREW
		5	1	RING GEAR, SLIDING
		6	10	CAPSCREW, 10-24
		7	1	GASKET
		8	1	THRUST WASHER
KIT 2	92077			DRUM SUPPORT KIT
		21	1	GEAR SIDE DRUM SUPPORT
		22	1	MOTOR SIDE DRUM SUPPORT
		23	2	BUSHING
KIT 3	86473			TIE ROD KIT
		24	2	TIE ROD
		25	4	5/16" BOLTS

KIT#	PN	ITEM	QTY	DESCRIPTION
KIT 4	92081			RING GEAR KIT
		7	1	GASKET
		13	1	CARRIER ASSEMBLY, STAGE 3
		14	1	RING GEAR
		33	1	SPLINED DRIVE GEAR
KIT 5	92087			CARRIER KIT
		10	1	SUN GEAR
		11	1	CARRIER ASSEMBLY, STAGE 1
		12	1	CARRIER ASSEMBLY, STAGE 2
		32	1	SHAFT, DRIVE
KIT 6	32455			BRAKE KIT
		30	1	COUPLER
		31	1	BRAKE
		32	1	SHAFT, DRIVE
		33	1	SPLINED DRIVE GEAR
KIT 7	86537			MOTOR KIT
		40	1	MOTOR
		45	1	SPACER
		54	1	GROUND BOLT
KIT 8	92075			CONTROL PACK KIT
		60	1	CONTROL PACK
		62	1	SOLENOID
		65	1	BRACKET
KIT 9	92067			BOLT AND GASKET KIT
		6	10	CAPSCREW, 10-24
		7	2	GASKET
		8	1	THRUST WASHER
		23	2	BUSHING
		25	4	5/16" BOLTS
		54	1	GROUND BOLT
		55	1	PARTS PACK
KIT 10	92036			LABEL KIT
INDIVIDUAL ITEMS				
	26107	26		DRUM ASSEMBLY
	86515	27		WIRE ROPE ASSEMBLY
	79626	28		TERMINAL KIT
	15901	53		GROUND CABLE
	90172	65		BRACKET
	38626	68		REMOTE ASSEMBLY
	5742	80		FAIRLEAD, ROLLER